

APPLICATIONS FOR AMENDMENTS TO THE TOWN'S OFFICIAL PLAN & ZONING BY-LAW

Nathanael Andoseh

19 Memory Lane.

Community of Pefferlaw



1: 2,257
May 4, 2017



Notes
This map was printed from a YorkMaps application.

GENERAL NOTES:

1. ALL SETBACKS AND ELEVATIONS TO BE CONFIRMED BY O.L.S. PRIOR TO PLACING ANY CONCRETE;
2. CONTRACTOR SHALL VERIFY BUILDING ELEVATIONS WITH ARCHITECTURAL DRAWINGS BEFORE FOUNDATION WORKS;
3. ALL GRADING TO BE COMPLETED IN STRICT ACCORDANCE WITH THE APPROVED PLAN. THE TOWN WILL BE CONSULTED PRIOR TO ANY CHANGES BEING MADE TO THE SITE GRADING. A REVISED PLAN OR AS-BUILT DRAWING MAY BE REQUIRED AT THE DISCRETION OF THE TOWN;
4. ALL DISTURBED AREAS SHALL BE RESTORED WITH 150MM TOPSOIL AND STABILIZED WITH SEED OR SOD;
5. SILT FENCE SHALL BE INSTALLED AROUND THE PERIMETER OF THE SITE PRIOR TO CONSTRUCTION, AND MAINTAINED FOR THE DURATION OF THE PROJECT;
6. DRAINAGE SWALES SHALL HAVE A MINIMUM DEPTH OF 0.15M AND ALL SLOPES SHALL BE CONSTRUCTED NO STEEPER THAN 3:1;
7. SURFACE AND ROOF RUNOFF SHALL BE DIRECTED AS DETAILED;
8. THE CONSULTANT'S FINAL LOT GRADING CERTIFICATE MIGHT BE REQUIRED & TO BE PROVIDED PRIOR TO THE TOWN'S FINAL INSPECTION AND DEPOSIT RELEASE.

LOT AREA: 1,153.1 SQ.M
 PROPOSED HOUSE AREA (INCL. PORCH) 132.8 SQ.M
 LOT COVERAGE: 11.5%

HOUSE ELEVATIONS:
 FFF = 229.40
 TFW = 229.10
 BS = 226.70
 USF = 226.55

NOTE: CONTRACTOR SHALL VERIFY BUILDING ELEVATIONS WITH ARCHITECTURAL DRAWINGS BEFORE FOUNDATION WORKS.

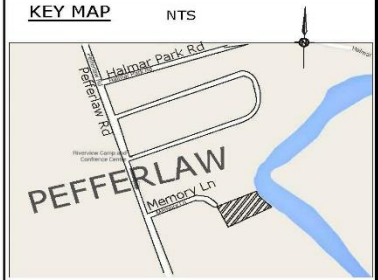
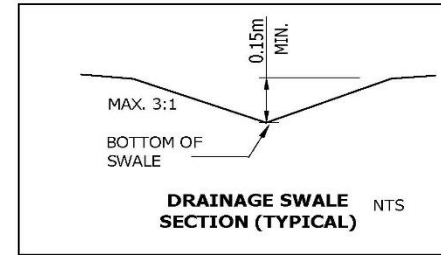

- LEGEND**
- x 100.02 EXISTING ELEVATIONS
 - x (99.95) SWALE ELEVATIONS
 - 100.02 PROPOSED ELEVATIONS
 - ☐ ROOF DOWNSPOUTS
 - ➔ SWALE DIRECTIONS
 - ↶ SURFACE DRAINAGE DIRECTIONS
 - HP ● HYDRO POLE
 - EXISTING TREE
 - TH#1 ▣ TEST HOLE (BY GEOPRO)

GEOTECHNICAL INVESTIGATION - SLOPE STABILITY ANALYSIS AND SETBACK STUDY - BY GEOPRO CONSULTING LIMITED, DATED MAY 16, 2016

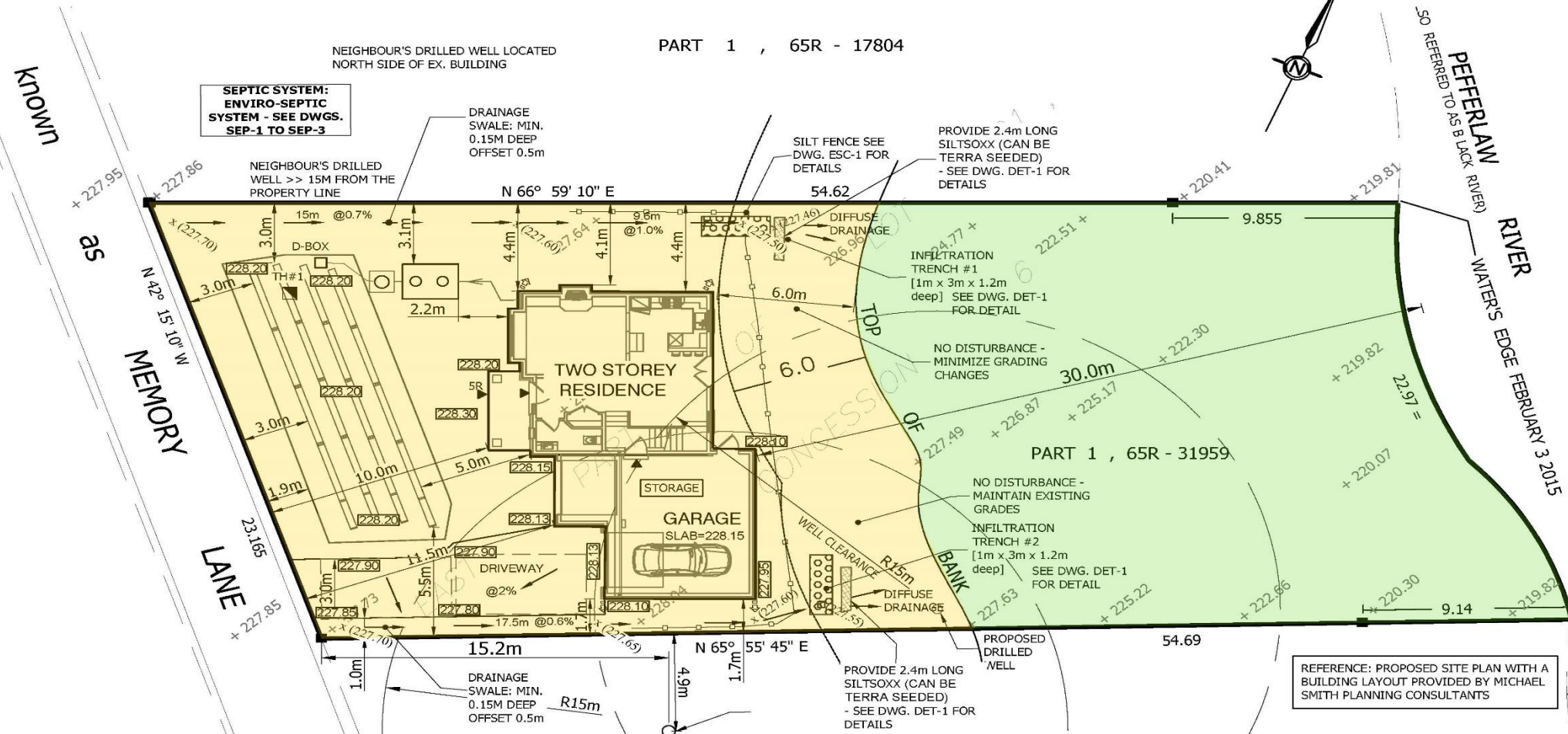

REV.1-JULY, 2018: RELOCATED BUILDING

ANDOSEH PROPERTY
 65R-31959
 17 MEMORY LANE
 TOWN OF GEORGINA

SITE GRADING PLAN

BJH Engineering Ltd.
 #25944 WOODBINE AVENUE, KESWICK, ONT L4P 3E9
 phone: 1.888.530.0699
 email: bjhongconsulting@gmail.com
 www.bjhengineering.ca

PROJECT NO.: **17-661**
 DRAWING NO.: **GP-1**
 Date: JAN, 2018
 Scale: 1 : 200
 Designed By: BH
 Drawn By: BH

REFERENCE: PROPOSED SITE PLAN WITH A BUILDING LAYOUT PROVIDED BY MICHAEL SMITH PLANNING CONSULTANTS