

Haley Homes Construction and John
Darragh
Proposed Zoning Amendment to
Permit
Two Semi Detached Dwellings
73 Burke Street, Sutton

GENERAL NOTES:

1. ALL GRADING TO BE COMPLETED IN STRICT ACCORDANCE WITH THE APPROVED PLAN. THE TOWN WILL BE CONSULTED PRIOR TO ANY CHANGES BEING MADE TO THE SITE GRADING. A REVISED PLAN OR AS-BUILT DRAWING MAY BE REQUIRED AT THE DISCRETION OF THE TOWN;
2. ALL DISTURBED AREAS SHALL BE RESTORED WITH 150MM TOPSOIL AND STABILIZED WITH SEED OR SOD;
3. SILT FENCE SHALL BE INSTALLED AROUND THE PERIMETER OF THE CONSTRUCTION SITE PRIOR TO CONSTRUCTION, AND MAINTAINED FOR THE DURATION OF THE PROJECT;
4. DRAINAGE SWALES SHALL HAVE A MINIMUM DEPTH OF 0.15M AND ALL SLOPES SHALL BE CONSTRUCTED NO STEEPER THAN 3:1;
5. SURFACE AND ROOF RUNOFF SHALL BE DIRECTED TOWARDS THE ROAD;
6. THE CONSULTANT'S FINAL LOT GRADING CERTIFICATE IS REQUIRED TO BE PROVIDED PRIOR TO THE TOWN'S FINAL INSPECTION AND DEPOSIT RELEASE.

SITE STATISTICS	A	B	C	D
LOT AREA (sq.m)	1,124	1,122	1,119	1,117
HOUSE FOOTPRINT (sq.m)	117.7	117.7	117.7	117.7
LOT COVERAGE (%)	10.5	10.5	10.5	10.5

HOUSE ELEVATIONS:	①	②	③	④
FFF	101.16	101.16	101.10	101.05
TFW	100.86	100.86	100.80	100.75
BS	98.46	98.46	98.40	98.35
USF	98.31	98.31	98.25	98.20

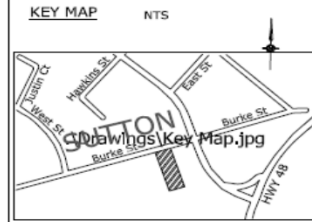

NOTE: NO DISTURBANCE TO EXISTING DRAINAGE DITCH

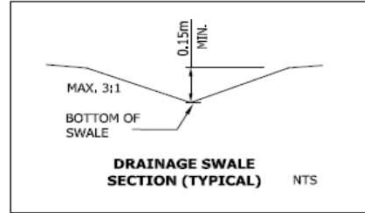
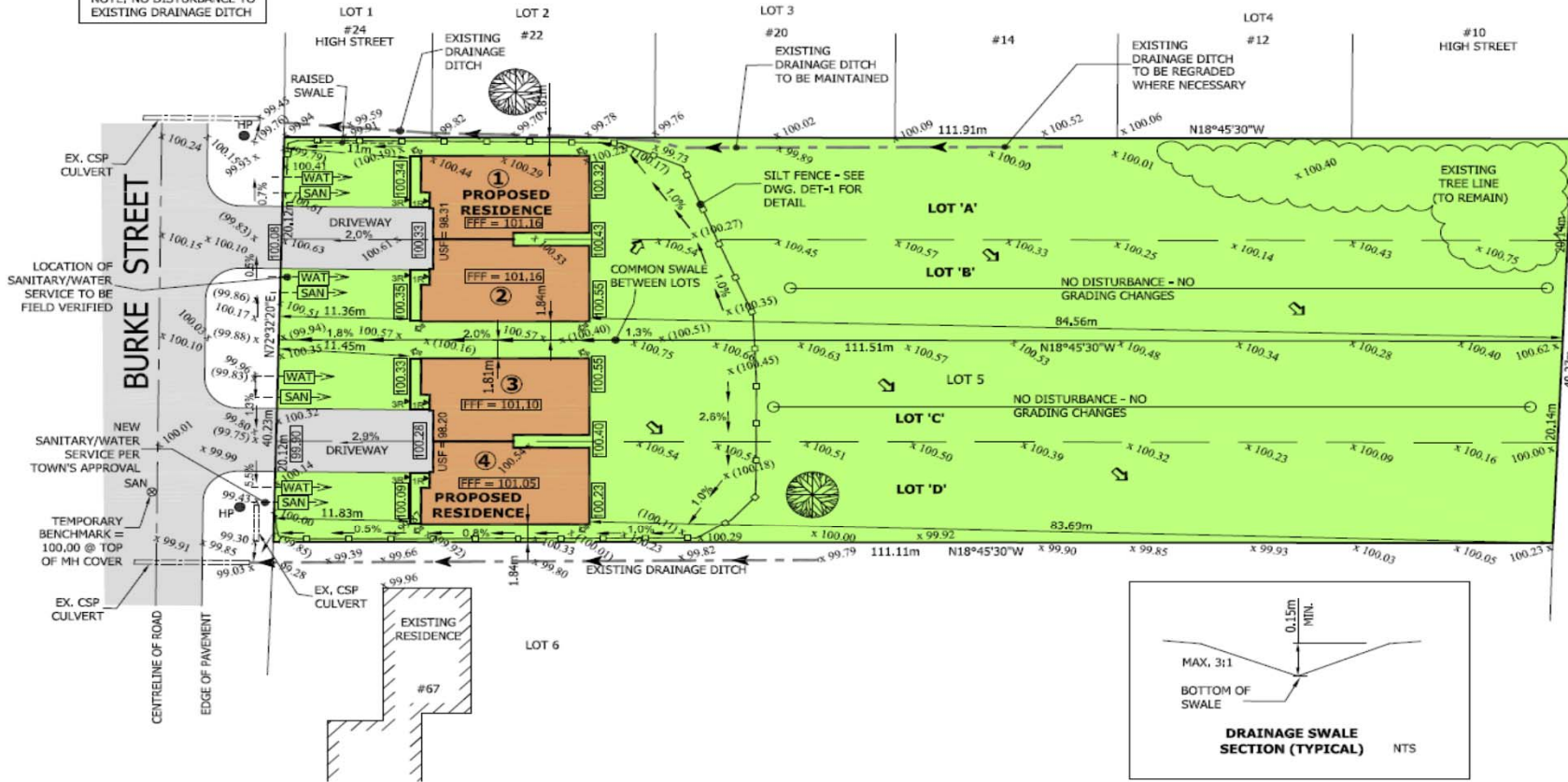

- LEGEND**
- x 100.02 EXISTING ELEVATIONS
 - x 99.95 SWALE ELEVATIONS
 - 100.02 PROPOSED ELEVATIONS
 - ↗ ROOF DOWNSPOUTS
 - SWALE DIRECTIONS
 - ↖ SURFACE DRAINAGE DIRECTIONS
 - HP HYDRO POLE
 - ⊙ EXISTING TREE
 - SAN SANITARY MAN-HOLE



HAYLEY HOMES CONSTRUCTION
 LOT 5, BLOCK 58
 R-PLAN 69
 ROLL NO.: 072-076
 73 BURKE STREET
 TOWN OF GEORGINA

SITE & GRADING PLAN

BJH Engineering Ltd.
 P.O. Box 1313,
 163 High Street, Sutton West,
 Ontario L0E 1R0
 phone: 1.888.530.0699
 email: bjhongconsulting@gmail.com
 www.bjhengineering.ca

PROJECT NO.: **16-295**
 DRAWING NO.: **GP-1**

Date: JAN, 2016 Designed By: BH
 Scale: 1 : 400 Drawn By: BH



BLUELINE Design

301.4222.8242
5.112014.HST.04
JCR/NC
305.172.6353

DATE Dec. 21, 2015
DRAWN BY CRB

CLIENT
John Darragh

PROJECT
Semi development
Burke, Georgia
PROJECT NO.
20150 21
REVISED

3D View
Proposed
Model

01