

**THE CORPORATION OF THE
TOWN OF GEORGINA**

**COUNCIL AGENDA
ADDENDUM**

Wednesday, January 20, 2016
9:00 AM

12. REPORTS

(2) REPORTS REQUIRING SEPARATE DISCUSSION

Report from the Recreation and Culture Department:

Pages 1-5

(B) Rewilding Design for The Link

Report No. RC-2016-0002

•Additional pages to the report's Attachment

ReWilding **THE LINK** ANTICIPATED ACTIVITY LEVEL PEOPLE

1

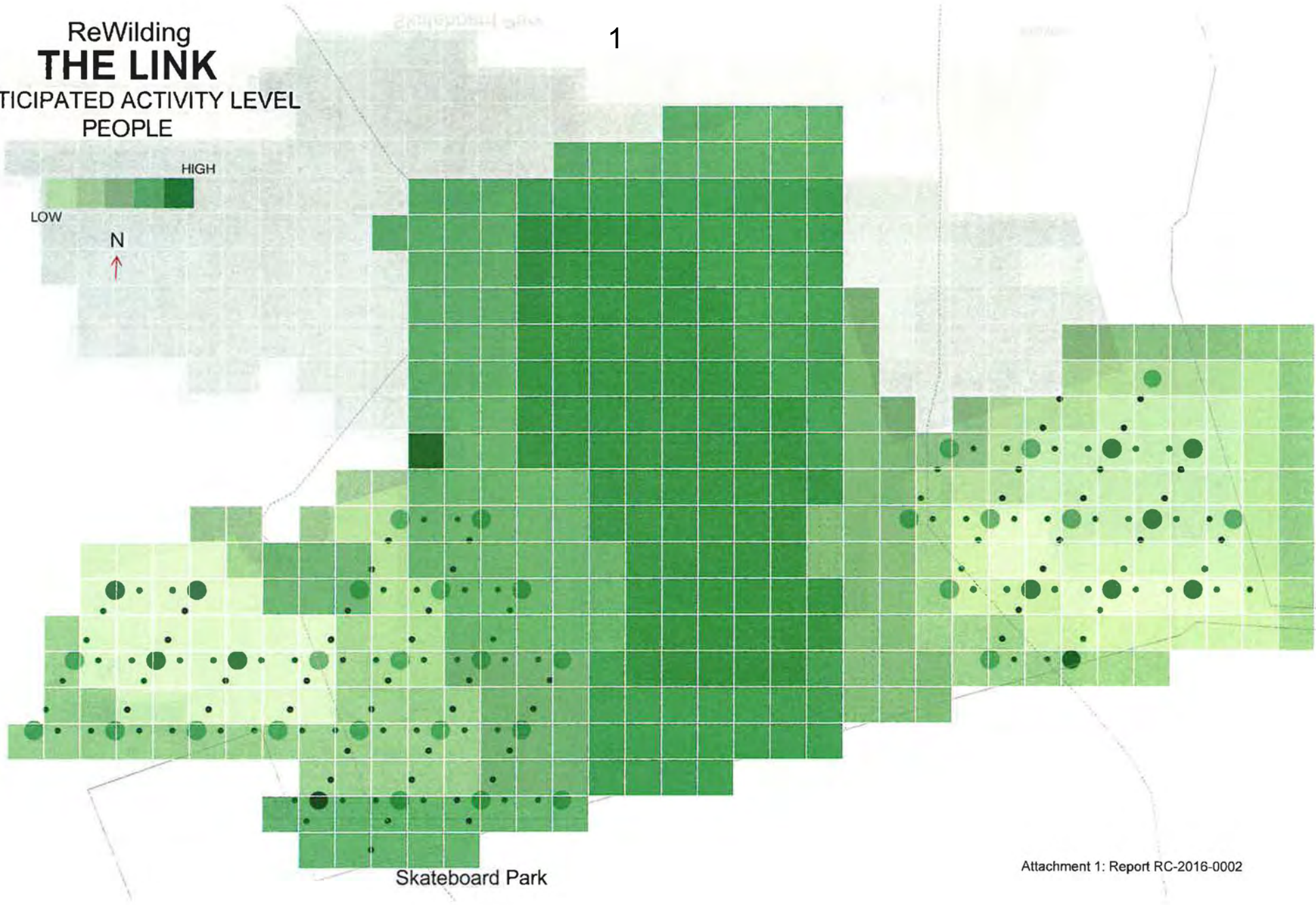
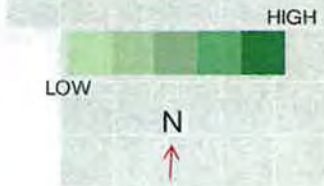

ReWilding THE LINK

ANTICIPATED ACTIVITY LEVEL
WATER

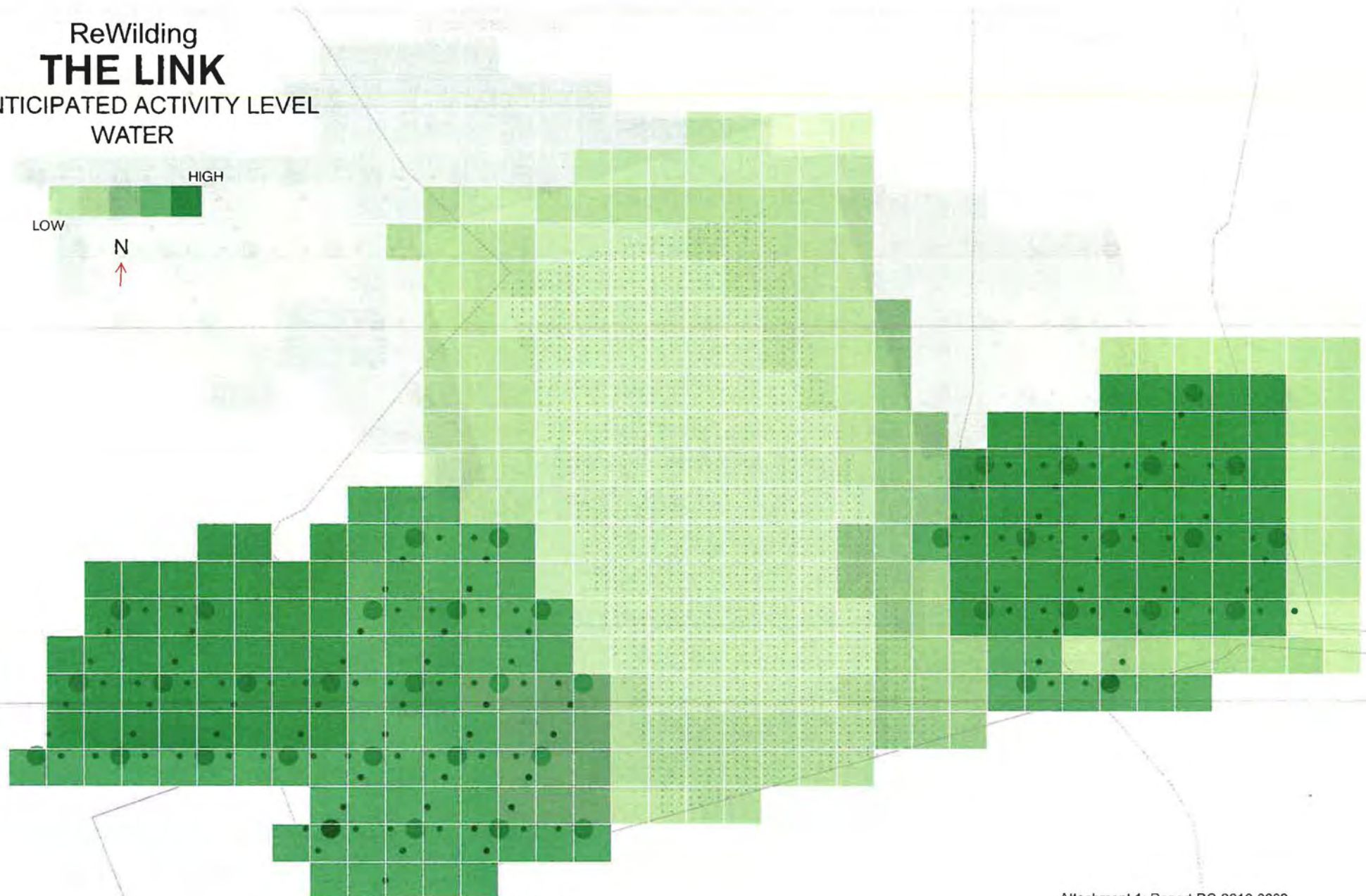
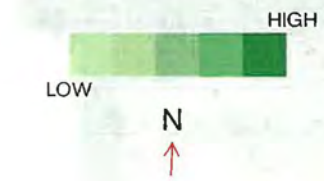

Skateboard Park

ReWilding THE LINK SITE PLAN

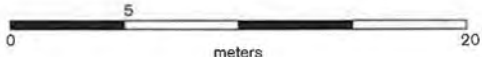

3

Market Place of Collaboration

The Link East Wing

FOREST OF POSSIBILITIES
Part I

"Plug and Play"
Examples

FOREST OF POSSIBILITIES
Part II

total area for
Forest of Possibilities I
±860m²

total area for Market Place
±750m²

total area for
Forest of Possibilities II
±480m²

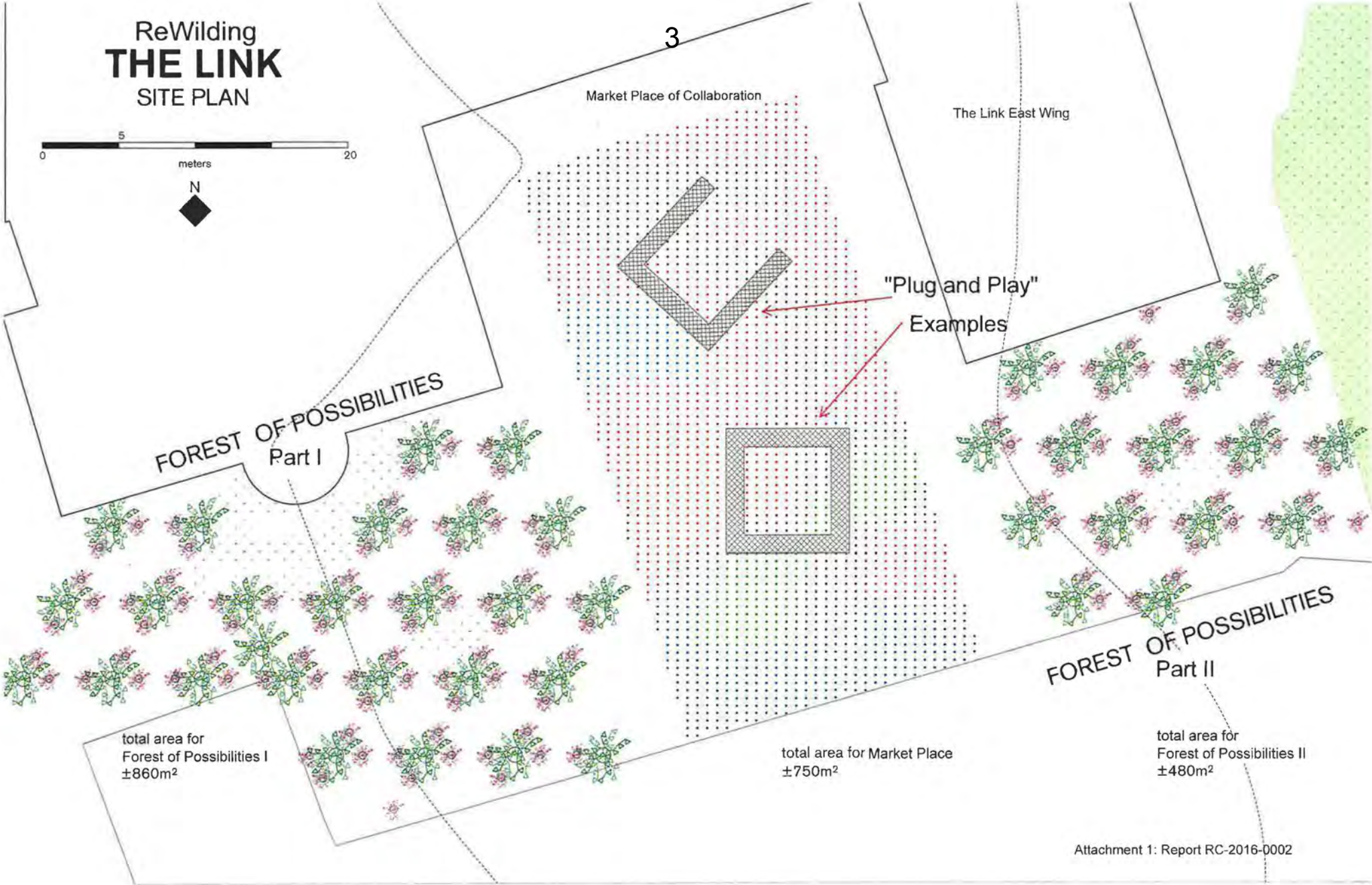

ReWilding **THE LINK** DETAIL DIMENSIONS FOR FOREST OF POSSIBILITIES I



Large public space
repaved with permeable
material

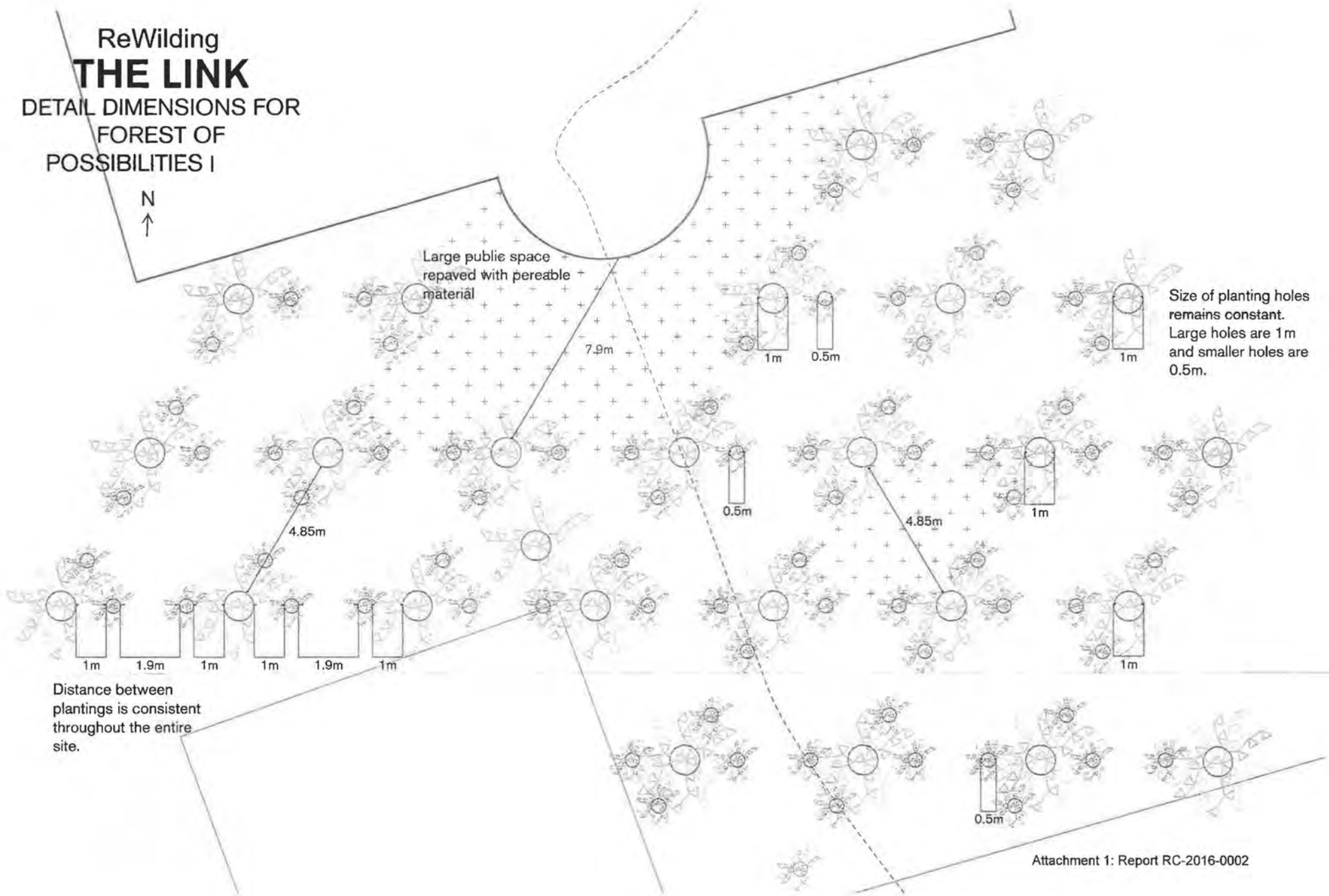

Size of planting holes
remains constant.
Large holes are 1m
and smaller holes are
0.5m.

Distance between
plantings is consistent
throughout the entire
site.

